

FE

(FEMALE ELBOW)

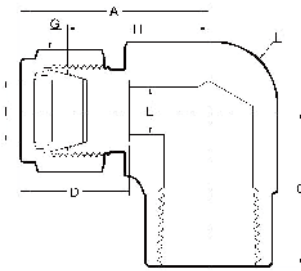

公制 (METRIC)

T TUBE O.D.	PT-NPT FEMALE PIPE SIZE	PART NO.	A	C	D	E	F	G	H
4	1/8	FE401	25.4	19.3	13.7	2.5	14	12	18.3
4	1/4	FE402	27.8	23.7	13.7	2.5	17	12	20.7
4	3/8	FE403	30.5	26.4	13.7	2.5	22	12	23.4
4	1/2	FE404	33.7	32.6	13.7	2.5	27	12	26.6
6	1/8	FE601	26.9	19.3	15.3	5.0	14	9/16	19.3
6	1/4	FE602	29.3	23.7	15.3	5.0	17	9/16	21.7
6	3/8	FE603	32.0	26.4	15.3	5.0	22	9/16	24.4
6	1/2	FE604	35.2	32.6	15.3	5.0	27	9/16	27.6
8	1/8	FE801	28.6	19.3	16.2	6.0	14	5/8	20.8
8	1/4	FE802	31.0	23.7	16.2	6.0	17	5/8	23.2
8	3/8	FE803	33.7	26.4	16.2	6.0	22	5/8	25.9
8	1/2	FE804	36.9	32.6	16.2	6.0	27	5/8	29.1
10	1/8	FE1001	31.6	23.7	17.2	8.0	17	19	23.7
10	1/4	FE1002	31.6	23.7	17.2	8.0	17	19	23.7
10	3/8	FE1003	34.3	26.4	17.2	8.0	22	19	26.4
10	1/2	FE1004	37.5	32.6	17.2	8.0	27	19	29.6
12	1/8	FE1201	36.7	25.0	22.8	10.0	20	7/8	27.0
12	1/4	FE1202	36.7	25.0	22.8	10.0	20	7/8	27.0
12	3/8	FE1203	36.1	26.4	22.8	10.0	22	7/8	26.4
12	1/2	FE1204	39.3	32.6	22.8	10.0	27	7/8	29.6
12	3/4	FE1206	49.2	41.0	22.8	10.0	34	7/8	39.5
14	1/8	FE1401	36.9	26.0	24.4	12.0	24	25	26.5
14	1/4	FE1402	36.9	26.0	24.4	12.0	24	25	26.5
14	3/8	FE1403	36.9	26.0	24.4	12.0	24	25	26.5
14	1/2	FE1404	40.0	32.6	24.4	12.0	27	25	29.6
14	3/4	FE1406	49.9	41.0	24.4	12.0	34	25	39.5
15	1/8	FE1501	37.0	26.0	24.4	12.0	24	25	26.5
15	1/4	FE1502	37.0	26.0	24.4	12.0	24	25	26.5
15	3/8	FE1503	37.0	26.0	24.4	12.0	24	25	26.5
15	1/2	FE1504	40.1	32.6	24.4	12.0	27	25	29.6
15	3/4	FE1506	50.0	41.0	24.4	12.0	34	25	39.5
16	1/8	FE1601	37.0	26.0	24.4	14.0	24	25	26.5
16	1/4	FE1602	37.2	26.0	24.4	14.0	24	25	26.5
16	3/8	FE1603	37.2	26.0	24.4	14.0	24	25	26.5
16	1/2	FE1604	40.3	32.6	24.4	14.0	27	25	29.6
16	3/4	FE1606	50.2	41.0	24.4	14.0	34	25	39.5
18	3/8	FE1803	40.0	32.6	24.4	16.0	27	30	29.6
18	1/2	FE1804	40.0	32.6	24.4	16.0	27	30	29.6
18	3/4	FE1806	49.9	41.0	24.4	16.0	34	30	39.5
20	3/8	FE2003	43.7	34.7	26.0	18.0	30	32	34.7
20	1/2	FE2004	43.7	34.7	26.0	18.0	30	32	34.7
20	3/4	FE2006	48.5	41.0	26.0	18.0	34	32	39.5
22	3/8	FE2203	44.0	34.7	26.0	18.0	30	32	34.7
22	1/2	FE2204	44.0	34.7	26.0	18.0	30	32	34.7
22	3/4	FE2206	48.8	41.0	26.0	18.0	34	32	39.5
25	1/2	FE2504	52.9	41.0	31.3	22.0	34	1-1/2	40.5
25	3/4	FE2506	52.9	41.0	31.3	22.0	34	1-1/2	40.5

ALL DIMENSIONS ARE IN MILLIMETERS UNLESS SPECIFIC. (除非另有說明，否則所有尺寸單位均為MM)
 IN COLUMN G, FRACTION NUMBERS MEAN INCH SIZE. (G欄數值若是分數，表示其單位是INCH)
 DIMENSIONS SHOWN ARE FOR REFERENCE ONLY AND SUBJECT TO CHANGE. (上述尺寸僅供參考，修改不另行通知)

FE

(FEMALE ELBOW)

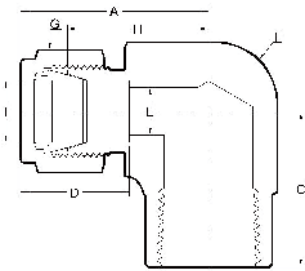

英制 (FRACTIONAL)

T TUBE O.D.	PT-NPT FEMALE PIPE SIZE	PART NO.	A	C	D	E	F	G	H
1/8	1/8	FE0101	25.2	19.3	12.7	2.5	14	7/16	18.3
1/8	1/4	FE0102	27.6	23.7	12.7	2.5	17	7/16	20.7
1/8	3/8	FE0103	30.3	26.4	12.7	2.5	22	7/16	23.4
1/8	1/2	FE0104	33.5	32.6	12.7	2.5	27	7/16	26.6
1/4	1/8	FE0201	27.1	19.3	15.2	5.0	14	9/16	19.3
1/4	1/4	FE0202	29.5	23.7	15.2	5.0	17	9/16	21.7
1/4	3/8	FE0203	32.2	26.4	15.2	5.0	22	9/16	24.4
1/4	1/2	FE0204	35.4	32.6	15.2	5.0	27	9/16	27.6
3/8	1/8	FE0301	29.0	19.3	16.8	7.7	14	11/16	21.3
3/8	1/4	FE0302	31.4	23.7	16.8	7.7	17	11/16	23.7
3/8	3/8	FE0303	34.1	26.4	16.8	7.7	22	11/16	26.4
3/8	1/2	FE0304	37.3	32.6	16.8	7.7	27	11/16	29.6
1/2	1/8	FE0401	36.9	25.0	22.9	10.0	20	7/8	27.0
1/2	1/4	FE0402	36.9	25.0	22.9	10.0	20	7/8	27.0
1/2	3/8	FE0403	36.3	26.4	22.9	10.0	22	7/8	26.4
1/2	1/2	FE0404	39.5	32.6	22.9	10.0	27	7/8	29.6
1/2	3/4	FE0406	49.4	41.0	22.9	10.0	34	7/8	39.5
5/8	3/4	FE0506	49.9	41.0	24.4	14.0	34	25	39.5
3/4	1/8	FE0601	40.5	32.6	24.4	16.0	27	1-1/8	29.6
3/4	1/4	FE0602	40.5	32.6	24.4	16.0	27	1-1/8	29.6
3/4	3/8	FE0603	40.5	32.6	24.4	16.0	27	1-1/8	29.6
3/4	1/2	FE0604	40.5	32.6	24.4	16.0	27	1-1/8	29.6
3/4	3/4	FE0606	50.4	41.0	24.4	16.0	34	1-1/8	39.5
1	1/2	FE0804	52.9	41.0	31.2	22.0	34	1-1/2	40.5
1	3/4	FE0806	52.9	41.0	31.2	22.0	34	1-1/2	40.5