

# ME

(MALE ELBOW)

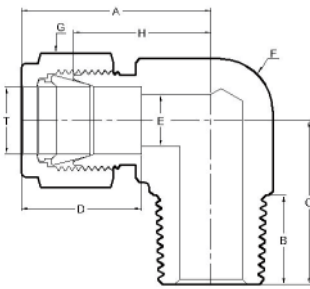

## 公制 (METRIC)

T TUBE O.D.	PT-NPT MALE PIPE SIZE	PART NO.	A	B	C	D	E	F	G	H
3	1/8	ME301	24.4	10.0	18.7	12.9	2.5	12	7/16	17.7
3	1/4	ME302	25.0	13.0	22.3	12.9	2.5	14	7/16	18.3
4	1/8	ME401	24.8	10.0	18.7	13.7	2.5	12	12	17.7
4	1/4	ME402	25.4	13.0	22.3	13.7	2.5	14	12	18.3
4	3/8	ME403	27.8	14.0	25.7	13.7	2.5	17	12	20.7
4	1/2	ME404	30.5	17.0	31.4	13.7	2.5	22	12	23.4
6	1/8	ME601	26.3	10.0	18.7	15.3	5.0	12	9/16	18.7
6	1/4	ME602	26.9	13.0	22.3	15.3	5.0	14	9/16	19.3
6	3/8	ME603	29.3	14.0	25.7	15.3	5.0	17	9/16	21.7
6	1/2	ME604	32.0	17.0	31.4	15.3	5.0	22	9/16	24.4
8	1/8	ME801	28.6	10.0	19.3	16.2	6.0	14	5/8	20.8
8	1/4	ME802	28.6	13.0	22.3	16.2	6.0	14	5/8	20.8
8	3/8	ME803	31.0	14.0	25.7	16.2	6.0	17	5/8	23.2
8	1/2	ME804	33.7	17.0	31.4	16.2	6.0	22	5/8	25.9
10	1/8	ME1001	31.6	10.0	21.7	17.2	8.0	17	19	23.7
10	1/4	ME1002	31.6	13.0	24.7	17.2	8.0	17	19	23.7
10	3/8	ME1003	31.6	14.0	25.7	17.2	8.0	17	19	23.7
10	1/2	ME1004	34.3	17.0	31.4	17.2	8.0	22	19	26.4
12	1/8	ME1201	36.2	10.0	24.5	22.8	10.0	20	7/8	26.5
12	1/4	ME1202	36.7	13.0	27.5	22.8	10.0	20	7/8	27.0
12	3/8	ME1203	36.7	14.0	27.4	22.8	10.0	20	7/8	27.0
12	1/2	ME1204	36.1	17.0	31.4	22.8	10.0	22	7/8	26.4
12	3/4	ME1206	39.3	19.0	36.6	22.8	10.0	27	7/8	29.6
12	1	ME1208	49.6	22.0	45.5	22.8	10.0	34	7/8	39.9
14	3/8	ME1403	36.9	14.0	28.0	24.4	12.0	24	25	26.5
14	1/2	ME1404	36.9	17.0	31.0	24.4	12.0	24	25	26.5
14	3/4	ME1406	40.0	19.0	36.6	24.4	12.0	27	25	29.6
14	1	ME1408	50.3	22.0	45.5	24.4	12.0	34	25	39.9
15	3/8	ME1503	37.0	14.0	28.0	24.4	12.0	24	25	26.5
15	1/2	ME1504	37.0	17.0	31.0	24.4	12.0	24	25	26.5
15	3/4	ME1506	40.1	19.0	36.6	24.4	12.0	27	25	29.6
16	3/8	ME1603	37.2	14.0	28.0	24.4	14.0	24	25	26.5
16	1/2	ME1604	37.2	17.0	31.0	24.4	14.0	24	25	26.5
16	3/4	ME1606	40.3	19.0	36.6	24.4	14.0	27	25	29.6
16	1	ME1608	50.6	22.0	45.5	24.4	14.0	34	25	39.9
18	3/8	ME1803	40.0	14.0	31.6	24.4	16.0	27	30	29.6
18	1/2	ME1804	40.0	17.0	34.6	24.4	16.0	27	30	29.6
18	3/4	ME1806	40.0	19.0	36.6	24.4	16.0	27	30	29.6
18	1	ME1808	50.3	22.0	45.5	24.4	16.0	34	30	39.9
20	3/8	ME2003	43.7	14.0	36.2	26.0	18.0	30	32	34.7
20	1/2	ME2004	43.7	17.0	38.7	26.0	18.0	30	32	34.7
20	3/4	ME2006	43.7	19.0	38.7	26.0	18.0	30	32	34.7
20	1	ME2008	48.9	22.0	45.5	26.0	18.0	34	32	39.9
22	3/8	ME2203	44.0	14.0	36.2	26.0	18.0	30	32	34.7
22	1/2	ME2204	44.0	17.0	38.7	26.0	18.0	30	32	34.7
22	3/4	ME2206	44.0	19.0	38.7	26.0	18.0	30	32	34.7
22	1	ME2208	49.2	22.0	45.5	26.0	18.0	34	32	39.9
25	1/2	ME2504	52.9	17.0	43.0	31.3	22.0	34	1-1/2	40.5
25	3/4	ME2506	52.9	19.0	45.0	31.3	22.0	34	1-1/2	40.5
25	1	ME2508	52.9	22.0	45.5	31.3	22.0	34	1-1/2	40.5

ALL DIMENSIONS ARE IN MILLIMETERS UNLESS SPECIFIC. (除非另有說明，否則所有尺寸單位均為MM)  
 IN COLUMN G, FRACTION NUMBERS MEAN INCH SIZE. (G欄數值若是分數，表示其單位是INCH)  
 DIMENSIONS SHOWN ARE FOR REFERENCE ONLY AND SUBJECT TO CHANGE. (上述尺寸僅供參考，修改不另行通知)

# ME

(MALE ELBOW)

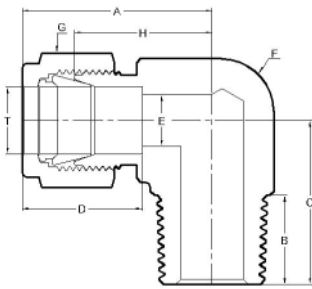

## 英制 (FRACTIONAL)

T TUBE O.D.	PT-NPT MALE PIPE SIZE	PART NO.	A	B	C	D	E	F	G	H
1/16	1/8	ME00501	19.7	10.0	18.7	8.6	1.5	12	10	15.7
1/16	1/4	ME00502	20.3	13.0	22.3	8.6	1.5	14	10	16.3
1/8	1/8	ME0101	24.6	10.0	18.7	12.7	2.5	12	7/16	17.7
1/8	1/4	ME0102	25.2	13.0	22.3	12.7	2.5	14	7/16	18.3
1/8	3/8	ME0103	27.6	14.0	25.7	12.7	2.5	17	7/16	20.7
1/8	1/2	ME0104	30.3	17.0	31.4	12.7	2.5	22	7/16	23.4
3/16	1/8	ME01501	24.6	10.0	18.7	13.7	2.5	12	12	17.7
3/16	1/4	ME01502	25.2	13.0	22.3	13.7	2.5	14	12	18.3
3/16	3/8	ME01503	27.6	14.0	25.7	13.7	2.5	17	12	20.7
3/16	1/2	ME01504	30.3	17.0	31.4	13.7	2.5	22	12	23.4
1/4	1/8	ME0201	26.5	10.0	18.7	15.2	5.0	12	9/16	18.7
1/4	1/4	ME0202	27.1	13.0	22.3	15.2	5.0	14	9/16	19.3
1/4	3/8	ME0203	29.5	14.0	25.7	15.2	5.0	17	9/16	21.7
1/4	1/2	ME0204	32.2	17.0	31.4	15.2	5.0	22	9/16	24.4
1/4	3/4	ME0206	35.4	19.0	36.4	15.2	5.0	27	9/16	27.6
1/4	1	ME0208	45.7	22.0	45.5	15.2	5.0	34	9/16	37.9
3/8	1/8	ME0301	29.0	10.0	19.3	16.8	7.7	14	11/16	21.3
3/8	1/4	ME0302	29.0	13.0	22.3	16.8	7.7	14	11/16	21.3
3/8	3/8	ME0303	31.4	14.0	25.7	16.8	7.7	17	11/16	23.7
3/8	1/2	ME0304	34.1	17.0	31.4	16.8	7.7	22	11/16	26.4
3/8	3/4	ME0306	37.3	19.0	36.4	16.8	7.7	27	11/16	29.6
3/8	1	ME0308	47.6	22.0	45.5	16.8	7.7	34	11/16	39.9
1/2	1/8	ME0401	36.9	10.0	25.0	22.9	10.0	20	7/8	27.0
1/2	1/4	ME0402	36.9	13.0	27.0	22.9	10.0	20	7/8	27.0
1/2	3/8	ME0403	36.9	14.0	27.5	22.9	10.0	20	7/8	27.0
1/2	1/2	ME0404	36.3	17.0	31.4	22.9	10.0	22	7/8	26.4
1/2	3/4	ME0406	39.5	19.0	36.4	22.9	10.0	27	7/8	29.6
1/2	1	ME0408	49.8	22.0	45.5	22.9	10.0	34	7/8	39.9
5/8	3/8	ME0503	36.9	14.0	28.0	24.4	14.0	24	25	26.5
5/8	1/2	ME0504	36.9	17.0	31.0	24.4	14.0	24	25	26.5
5/8	3/4	ME0506	40.0	19.0	36.6	24.4	14.0	27	25	29.6
3/4	3/8	ME0603	40.5	14.0	31.6	24.4	16.0	27	1-1/8	29.6
3/4	1/2	ME0604	40.5	17.0	34.6	24.4	16.0	27	1-1/8	29.6
3/4	3/4	ME0606	40.5	19.0	36.6	24.4	16.0	27	1-1/8	29.6
3/4	1	ME0608	50.8	22.0	45.5	24.4	16.0	34	1-1/8	39.9
1	1/2	ME0804	52.9	17.0	43.5	31.2	22.0	34	1-1/2	40.5
1	3/4	ME0806	52.9	19.0	45.5	31.2	22.0	34	1-1/2	40.5
1	1	ME0808	52.9	22.0	45.5	31.2	22.0	34	1-1/2	40.5

ALL DIMENSIONS ARE IN MILLIMETERS UNLESS SPECIFIC. (除非另有說明，否則所有尺寸單位均為MM)  
 IN COLUMN G, FRACTION NUMBERS MEAN INCH SIZE. (G欄數值若是分數，表示其單位是INCH)  
 DIMENSIONS SHOWN ARE FOR REFERENCE ONLY AND SUBJECT TO CHANGE. (上述尺寸僅供參考，修改不另行通知)